

PRODUCT DESCRIPTION

Patent Number: US D698,075 S



Closet Rated

- A movable insert for LEDs enabling four different lighting angles
- Four beam angles: 10, 30, 60 and 90 degrees
- Housing for LED strips that are up to 10mm wide (0.4")
- ETL listed and approved for installation in all closet storage areas when factory built by KLUS as fixtures with 4.5w/ft or less.

FINISH :

Silver anodized ☐



Fill empty fields

Product nr.	
Fixture type	
Company	
Job name	
Date	

TECHNICAL SPECIFICATION

Application

- extrusion for construction of surface mounted fixtures with a focused beam of light

Assembly

- with screws appropriately selected for the surface
- with mounting brackets
- with suspension accessories
- with mounting adhesives

Additional information

- the insert setting adjustment enables 10, 30, 60 and 90 degree beam angles
- eliminates obstacles related to LED light strip mounting
- extrusion acts as the connector between the light source and the application area and provides a stylish and finished look
- lighting or illumination of certain areas (stream of light may vary depending on the power of applied LEDs)
- extrusion can be made waterproof (IP 67) and be used as an outdoor lighting for elevations or architectural elements of gardens

Turn off LED lights during peak day light hours in outdoor applications to avoid excessive heat buildup which will result in diminished LED life.

TECHNICAL DRAWING

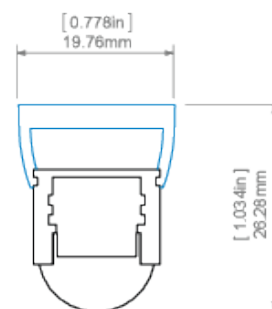
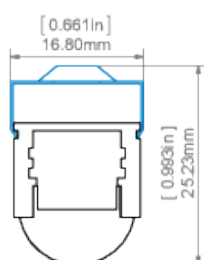
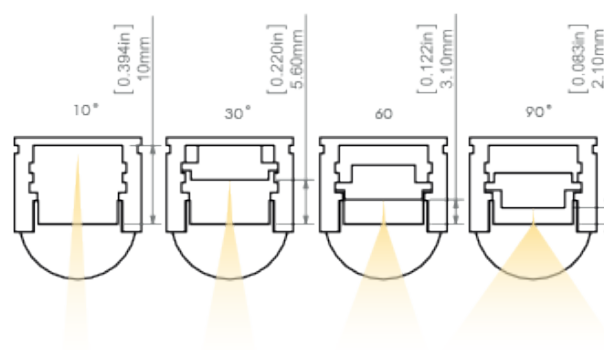
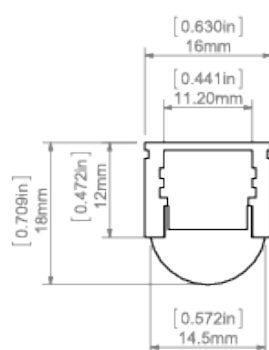

REGULOR extrusion and PDS-STN mounting bracket

REGULOR extrusion and PL-PDM mounting bracket

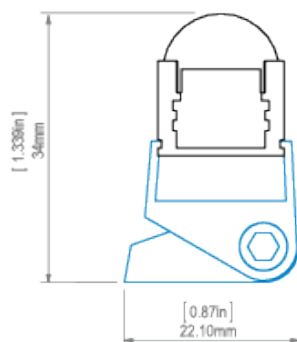

REGULOR extrusion and REG-PD-UV mounting bracket

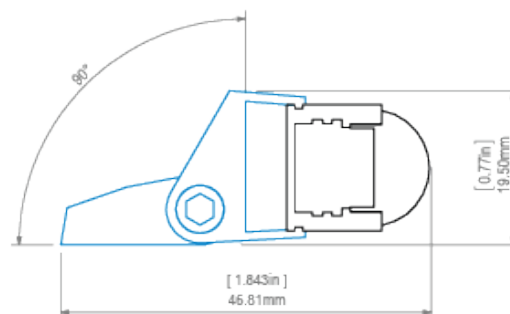

REGULOR extrusion and REG-PD-UV mounting bracket

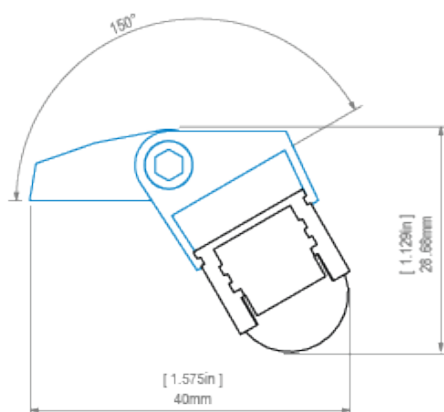

REGULOR extrusion and REG-PD-UV mounting bracket

RELATED PRODUCTS

COVERS

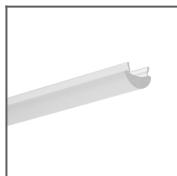

SATIN-S
Focusing Cover
Ref: 17111

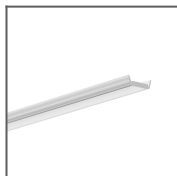

HS Cover clear
Ref: 1370



KA-BIS Cover
clear
Ref: 17072

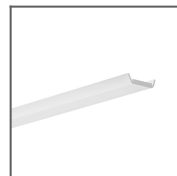

HS Cover frosted
Ref: 1369

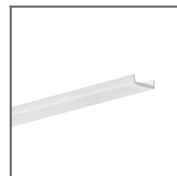

LIGER Cover
frosted
Ref: 17031

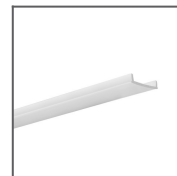

KA-BIS Cover
frosted
Ref: 17071

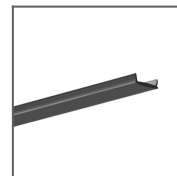

LIGER black
Cover
Ref: 17040

END CAPS



REGULOR-OTW
End cap
Ref: 00313



Electricity
conductive
PDS4-ALU End
cap
Ref: 1407



REGULOR End
cap
Ref: 00310

ACCESSORIES



BZP Head
Ref: 42213



BZP-ZZ Head
conductive
Ref: 42215



ST Head
Ref: 42216



ZZ Head
conductive
Ref: 42218

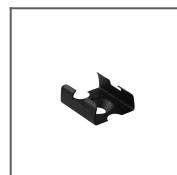

Black PDS/
MICRO Mounting
bracket
Ref: 24189

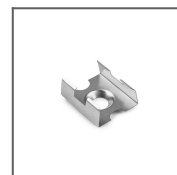

PDS-STN
Mounting
bracket
Ref: 24190

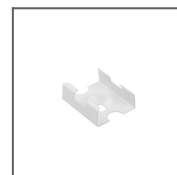

White PDS/
MICRO Mounting
bracket
Ref: 24223



DP-MOC
Fastener
Ref: 00645

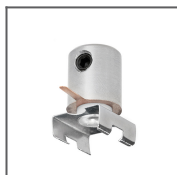

DP-MOC-ZZ
Fastener
Ref: 00647



DP-ZZ Fastener
Ref: 00651

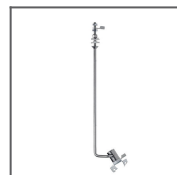

M14 Mounting
set
Ref: 42612



M3 Mounting set
Ref: 42303



M4 Mounting set
Ref: 42301



M5 Mounting set
Ref: 42302

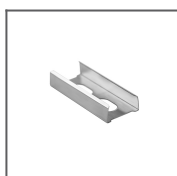

PD-MICRO
Connector
Ref: 42150



8,8x1,2 Gland
Ref: 00802